

N-MB.

A-MB.

DIMENSIONS

DESCRIPTION

The radial fan assembled on MIX dust collector filters, creates a vacuum to convey the dust from the point where it is generated and conveyed to the filter, allowing effective dust removal.

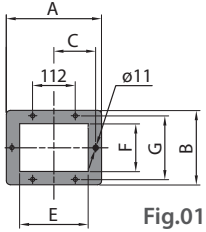

Fig.01

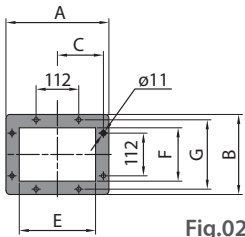

Fig.02

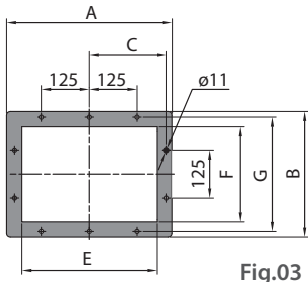

Fig.03

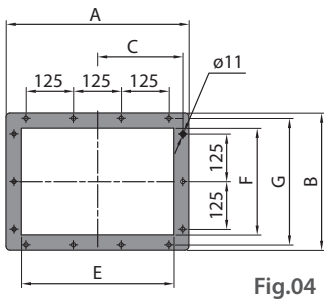

Fig.04



| kW | Fig. | A | B | C | E | F | G | H* | kg |
|------|------|-----|-----|-------|-----|-----|-----|-----|-----|
| 0,75 | 1 | 230 | 182 | 100 | 156 | 112 | 153 | 375 | 32 |
| 1,1 | | | | | | | | 34 | |
| 1,5 | 1 | 250 | 195 | 109,5 | 180 | 125 | 167 | 400 | 40 |
| 2,2 | | | | | | | | 425 | 43 |
| 3 | 2 | 270 | 210 | 120,5 | 200 | 140 | 182 | 475 | 62 |
| 4 | | | | | | | | 495 | 70 |
| 5,5 | 3 | 435 | 330 | 202,5 | 355 | 250 | 300 | 650 | 95 |
| 7,5 | | | | | | | | 690 | 107 |
| 11 | 4 | 480 | 360 | 224 | 400 | 280 | 332 | 805 | 160 |

* The value may change of +/- 50 ÷ 100 mm depending on the brand of the electric motor.

MOTOR POWER

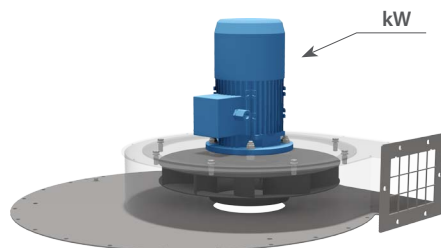

| kW | 0,75 | 1,1 | 1,5 | 2,2 | 3 | 4 | 5,5 | 7,5 | 11 |
|--------|------|-----|-----|-----|---|---|-----|-----|----|
| DN350 | ✓ | ✓ | ✓ | | | | | | |
| DN540 | ✓ | ✓ | ✓ | ✓ | | | | | |
| DN790 | | ✓ | ✓ | ✓ | ✓ | ✓ | ✓ | ✓ | |
| DN950 | | | ✓ | ✓ | ✓ | ✓ | ✓ | ✓ | ✓ |
| DN1100 | | | ✓ | ✓ | ✓ | ✓ | ✓ | ✓ | ✓ |
| DN1300 | | | | | | ✓ | ✓ | ✓ | ✓ |
| DN1500 | | | | | | ✓ | ✓ | ✓ | ✓ |

NOTE: All dimensions in mm, unless stated otherwise. The Company MIX reserves the right to alter product specifications without prior notice. All the quoted sizes are approximate. The given figures are mean values with tolerances entailed by the customary production-related variations. In any particular case, and to have the correct values, our written confirmation is necessary.

FANS' CURVES

MBS 360 1,1 kW

MBS 330 0,75 kW

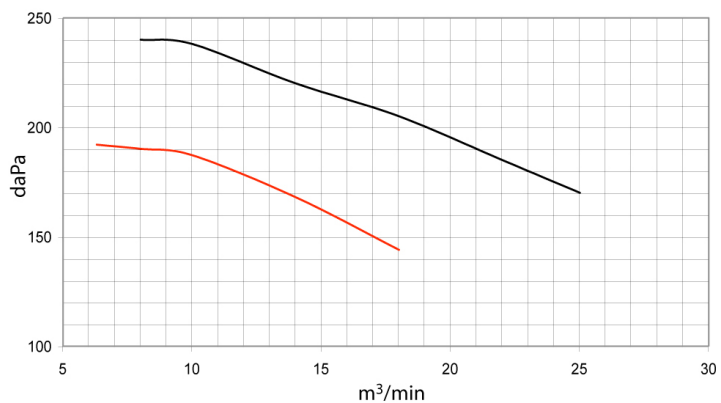

MBS 415 2,2 kW

MBS 385 1,5 kW

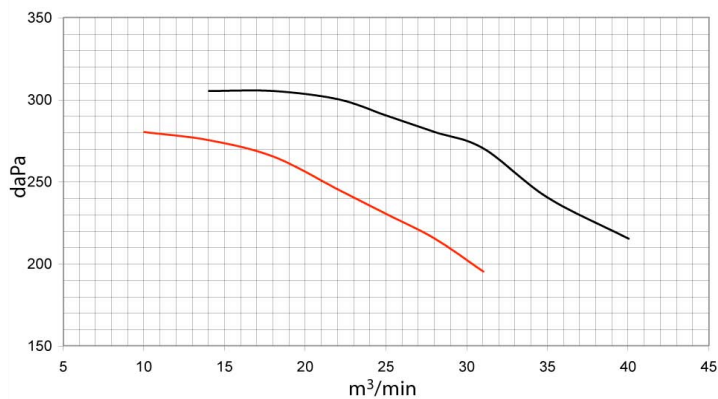

MBS 460 4 kW

MBS 430 3 kW

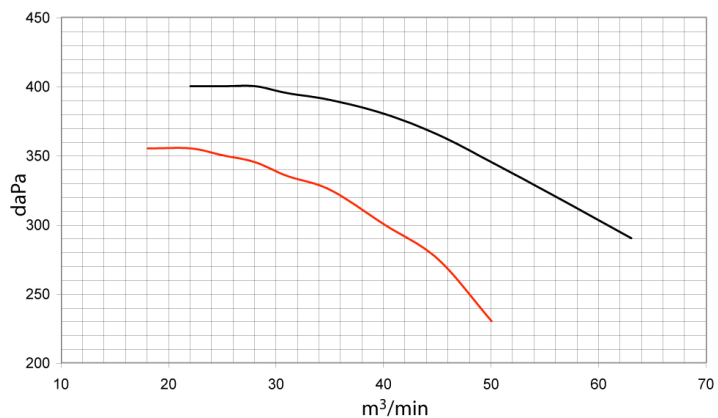

MBV 455 7,5 kW

MBV 420 5,5 kW

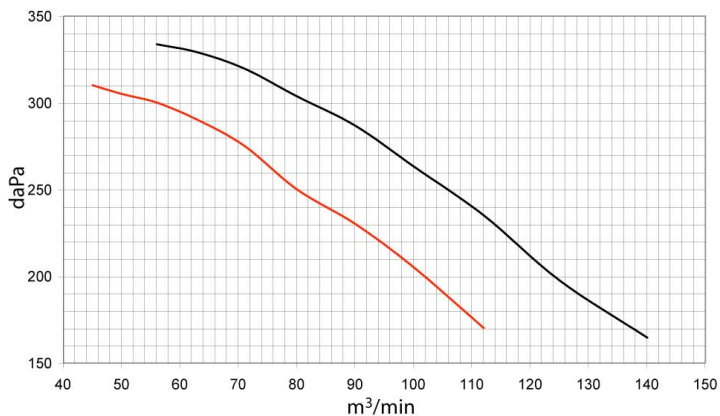

MBV 500 11 kW

