

N-SFT....

T-SFT....

DIMENSIONS

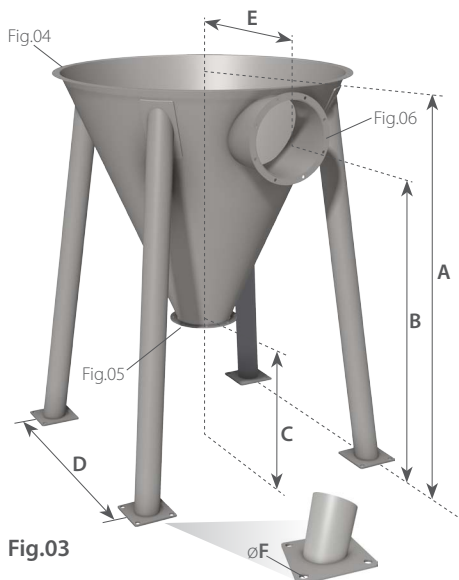
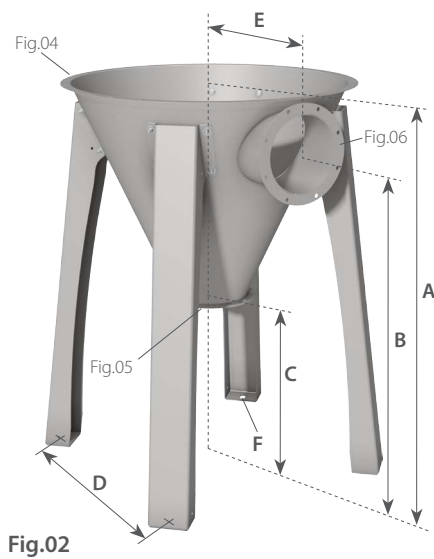
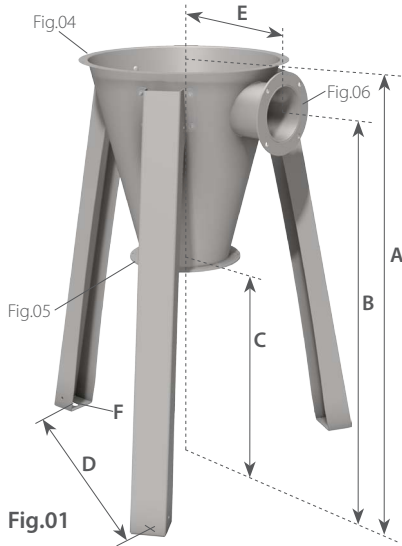

DESCRIPTION

The pre-separating hopper is usually placed under the filter to convey the air and favor a first decantation of the powder.

COMBINATION TABLE

N-SFT E F 05 A 1 H 1 N

Classification
MSD

Diameter of the mouth

- A: 80 (DN350)
- C: 150 (DN540)
- D: 200 (DN790)
- E: 250 (DN950-1100)
- F: 320 (DN1300-1550)

Hopper diameter

- 05: 350
- 10: 540
- 20: 790
- 22: 950
- 24: 1100
- 26: 1300
- 28: 1550

Type

- F: Flanged
- K: Complete with wheeled bucket

Execution

- N-SFTE: Standard
- T-SFTE: Suitable for potentially explosive environment

Execution

- N: Atmospheric
- V: Vacuum
- P: Standard and capable of withstanding the overpressure shock caused by an explosion (T-execution only)
- R: Vacuum and capable of withstanding the overpressure shock caused by an explosion (T-execution only)

Construction material

- 1: Carbon steel
- 2: Parts in contact with product in AISI 304 Supporting legs in Carbon steel

Fastening of mouth

- H: Flanged (Welded)

Quantity of mouths

- 1: 1 mouth
- 3: 3 mouths (special on request)
- A: 1 mouth with a reduction disc
- C: 1 mouth with a cyclonic modular device

CODE			Fig.	DN	A	B	C	D	E	F	Kg	dm ³
See combination table												
N-	T-	SFTEF	01	350	955	890	625	625	230	30X14	19,7	17
N-	T-	SFTEF	01	540	1210	1090	625	875	350	40x18	33,7	74
N-	T-	SFTEF	01	790	1350	1205	625	873	460	40X22	50,4	165

CODE			Fig.	DN	A	B	C	D	E	F	Kg	dm ³
See combination table												
N-	T-	SFTEF	02	950	1400	1230	625	820	555	40x22	98	245
N-	T-	SFTEF	02	1100	1535	1335	625	890	600	40X22	118	370

CODE			Fig.	DN	A	B	C	D	E	F	Kg	dm ³
See combination table												
N-	T-	SFTEF	03	1300	1815	1620	625	1155	770	21ø	152	645
N-	T-	SFTEF	03	1550	2000	1805	625	1334	885	21ø	182	960

FASTENING FLANGE TO THE DUST FILTER

Fig.04

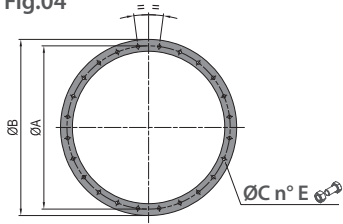

DN	ØA	ØB	ØC	n°E	
350	382	402	9	12	M8
540	570	590	9	16	M8
790	820	840	9	24	M8
950	996	1024	11	28	M10
1100	1154	1182	11	32	M10
1300	1338	1365	11	36	M10
1550	1588	1615	11	44	M10

OUTLET FLANGE

Fig.05

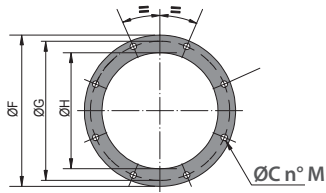

DN	ØF	ØG	ØH	ØL	n°M
350	225	200	150	14	4
540	325	300	250	14	8
790	325	300	250	14	8
950	325	300	250	14	8
1100	325	300	250	14	8
1300	325	300	250	14	8
1550	325	300	250	14	8

INLET FLANGE

Fig.06

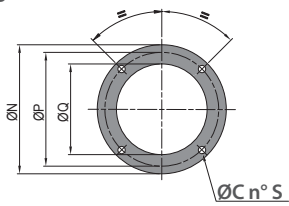

DN	ØN	ØP	ØQ	ØR	n°Sn°M
350	160	130	70	14	4
540	225	200	146	14	4
790	275	250	200	14	4
950	325	300	250	14	8
1100	325	300	250	14	8
1300	380	350	318	14	8
1550	380	350	318	14	8

CONFIGURATION

See specific data sheet

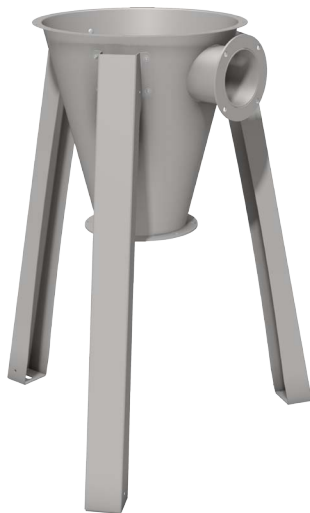

N-SFTEF



N-SFTEK
DN 350



N-SFTEK
DN 540 ÷ DN 1550

At the discharge of the **DN 350** hoppers only butterfly valves with long shaft can be applied

NOTE: All dimensions in mm, unless stated otherwise. The Company MIX reserves the right to alter product specifications without prior notice. All the quoted sizes are approximate. The given figures are mean values with tolerances entailed by the customary production-related variations. In any particular case, and to have the correct values, our written confirmation is necessary.